

R. L. GERMANN, P.E., P.S.

JANUARY 5, 1976

*1175 Independence*

CITY of NAPOLEON  
BUILDING DIVISION  
Napoleon, Ohio 43545

CERTIFICATE of COMPLIANCE

Project: Napoleon Warehouse  
Building A and B  
Napoleon, Ohio

I hereby certify to the best of my knowledge and belief, that the plans and specifications for the above mentioned project are in compliance with the City of Napoleon zoning ordinances for construction in a I-1 zoning district.

Very truly yours,

*R. L. Germann*  
\_\_\_\_\_  
R. L. Germann, P.E., P.S.

RLG/ek



FLOYD G. BROWNE AND ASSOCIATES, LIMITED  
CONSULTING ENGINEER - PLANNER  
MARION, OHIO

MEMO TO Tom Terranova DATE 3.8.77  
SUBJECT Plan Review JOB NO. \_\_\_\_\_  
FROM R.C. Jones TITLE \_\_\_\_\_

---

Time charged to Plan Review for the following buildings:

Universal Cooperatives, Inc. Sprinkler System	3.4.77	1 hour
Napoleon Warehouse, Inc. New Warehouse Building	3.8.77	1 hour

RECEIVED

MAR 10 1977

CITY OF NAPOLEON  
BUILDING DEPT

BY: [Signature]

No. ...121.....

CERTIFICATE OF OCCUPANCY  
THE CITY OF NAPOLEON

BUILDING DEPARTMENT  
DIVISION OF INSPECTION

This is to certify that the Building or Land as herein described complies with all the building and health laws and ordinances and with the provisions of the Zoning Ordinance.

Location of Occupancy ..... 50 Industrial Dr. .... Occupancy ..... Storage Warehouse (Chapter 4101:2-71 O.A.C.)

Owner of Property ..... Napoleon Warehouse, Inc. .... Address ..... 50 Industrial Dr.

Issued to ..... Napoleon Warehouse, Inc. .... Address ..... 50 Industrial Dr.

Zoning ..... "I-1" Enclosed Industrial District ..... Bldg. Permit No. .... 667-77

Substantial qualifications of occupancy ..... elevation, they shall be provided with stairs and a landing in accordance with Section 4101:2-23-42 and 4101:2-23-48 of the Ohio Administrative Code.

This certificate is issued by the City Building Inspector, as provided by law, and is to certify that construction is completed substantially in conformity with the approved plans and permission is hereby granted to occupy such building in compliance with such legal use and occupancy as authorized under the provisions of the ordinances of the City of Napoleon.

Issued this ..... 2nd ..... day of ..... August, ..... 19... 77

This is a valuable record for owner or lessee and should be so preserved.

Signed *Ronald E. Samuels*  
City Building Inspector



**Fast Food Merchandisers, Inc.**

2-11-85

Richard G. Hayman  
255 Riverview Avenue  
Napoleon, OH 43545

Dear Sir,

This letter is to confirm our conversation on February 5, 1985. The Fast Food Merchandisers sign, along side of Industrial Drive, will be moved when the frost is out of the ground. This sign will be moved by May 15, 1985.

If I can be of any further help in this matter, please give me a call.

Sincerely,

Joe Dietrich  
Fast Food Merchandisers

*6/15/85  
sign allowed to  
stay where it is by City Manager*





# City of NAPOLEON, OHIO

255 RIVERVIEW AVENUE - (419) 592-4010  
NAPOLEON, OHIO 43545-0151

January 22, 1985

Mayor  
Robert G. Heft

Clerk-Treasurer  
Rupert W. Schweinhagen

Members of Council  
Darel Austermilller, President  
William Young  
Lawrence Haase  
Darrell Fox  
Donald Morford  
Lynn Wachtmann

City Manager  
Richard A. Hayward

Law Director  
Keith P. Muehlfield

Fast Food Merchandising  
1175 Industrial Dr.  
Napoleon, OH 43545

Dear Sir:

The installation of receptacles along the parking area along Industrial Drive shall be required to be Ground Fault protected. On January 22, 1985, I noticed when passing the parking lot, that an extension cord was lying in the snow connected to the recepticle.

This constitutes a hazard to personnel and shall be protected by Gound Fault Circuits. These recepticle circuits shall be GFCI protected within 15 days of date of this notice.

It was also viewed that a sign has been installed near the street at the west end of the parking area. A permit is required for this sign. Also, a picture of the sign is needed with the size.

Your cooperation is appreciated.

Yours truly,

Richard G. Hayward  
Building Commissioner

RGH:dd

*Permit  
209*



# City of NAPOLEON, OHIO

255 RIVERVIEW AVENUE - (419) 592-4010  
NAPOLEON, OHIO 43545-0151

January 22, 1985

Mayor  
Robert G. Heft

Fast Food Merchandising  
1175 Industrial Dr.  
Napoleon, OH 43545

Clerk-Treasurer  
Rupert W. Schweinhagen

Dear Sir:

Members of Council  
Darel Austermilller, President  
William Young  
Lawrence Haase  
Darrell Fox  
Donald Morford  
Lynn Wachtmann

The installation of recepticles along the parking area along Industrial Drive shall be required to be Ground Fault protected. On January 22, 1985, I noticed when passing the parking lot, that an extension cord was lying in the snow connected to the recepticle.

City Manager  
Richard A. Hayward

This constitutes a hazard to personnel and shall be protected by Gound Fault Circuits. These recepticle circuits shall be GFCI protected within 15 days of date of this notice.

Law Director  
Keith P. Muehlfeld

It was also viewed that a sign has been installed near the street at the west end of the parking area. A permit is required for this sign. Also, a picture of the sign is needed with the size.

Your cooperation is appreciated.

Yours truly,

Richard G. Hayman  
Building Commissioner

RGH:dd



VARCO-PRUDEN, INC.

DESIGN MANUAL

Panel Rib

Varco-Pruden Panel Rib Engineering Data

- 1.) Total Layout = 43 1/8"
- 2.) Total Cover = 36"
- 3.) Galvanizing is 1.25 ounces per square foot
- 4.) Yield Stress for Steel is 50,000 psi
- 5.) Section Properties

Gage	t in.	*wt/sq. foot of cover lbs.	Top of Rib in Compression		Top of Rib in Tension	
			Sx	Ix	Sx	Ix
			in. <sup>3</sup>	in. <sup>4</sup>	in. <sup>3</sup>	in. <sup>4</sup>
26	0.0217	1.08	0.0451	0.0419	0.0493	0.0419
24	0.0279	1.40	0.0623	0.0565	0.0644	0.0554
22	0.0339	1.69	0.0798	0.0710	0.0804	0.0703

\*(weight based on 41.82 pounds per sq. ft. per inch thickness)

(R1)

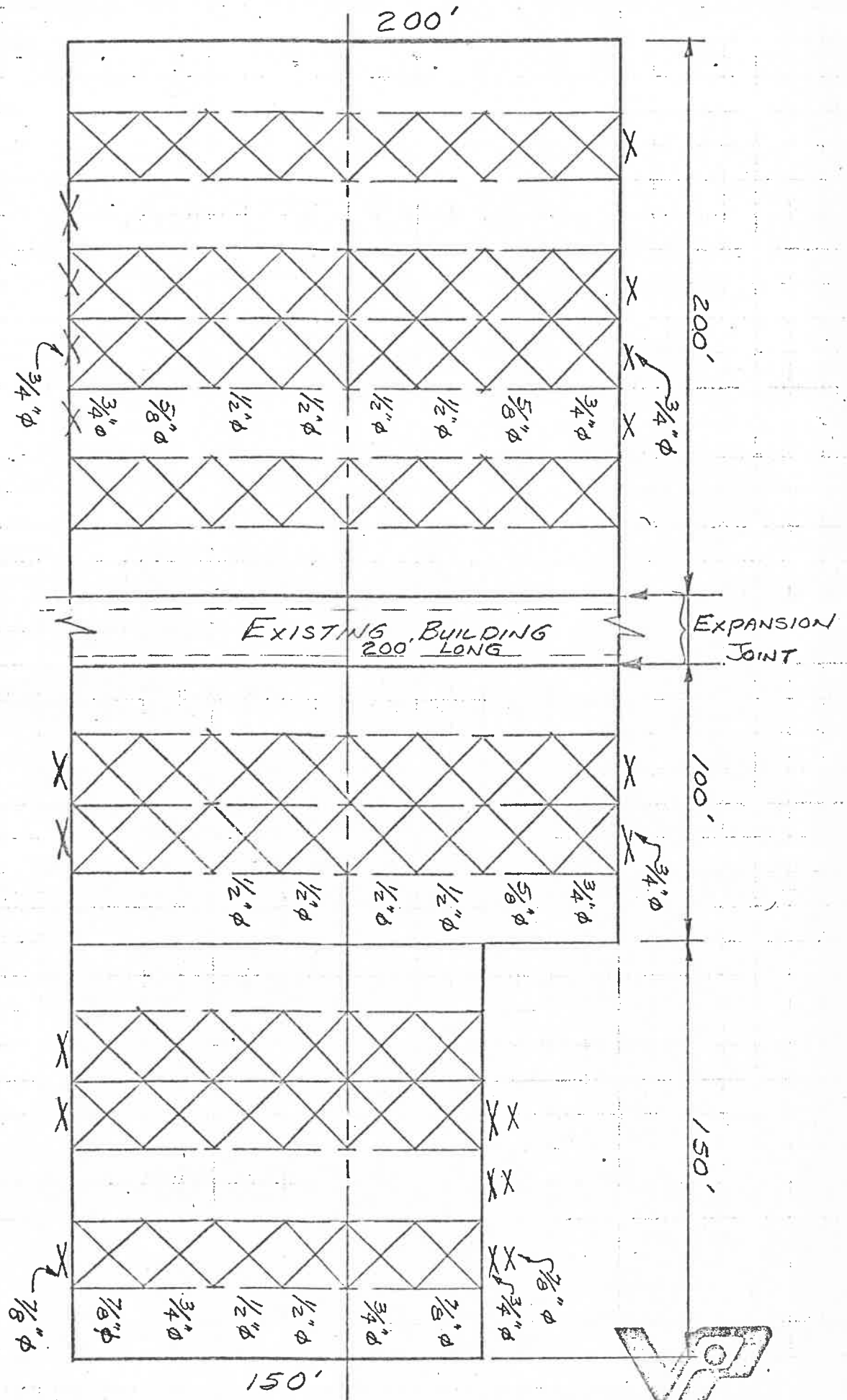



# WIND BRACING

150' x 24' / 28.17'

N-2520  
2-17-75 (RDK)

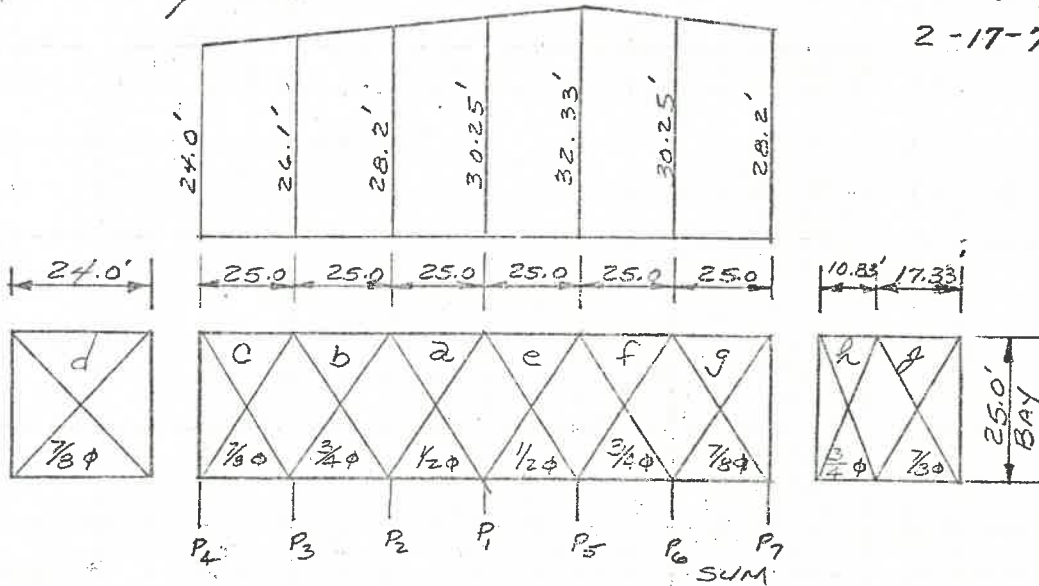

$$P_1 = \frac{20 \text{ psf} \times 25.0 \times 30.25}{1000 (2) (3)} = 2.52 = 2.52^k$$

$$P_2 = \frac{20 \text{ psf} \times 25 \times 28.2}{1000 (2) (3)} = 2.35^k = 4.87^k$$

$$P_3 = \frac{20 \text{ psf} \times 25 \times 26.1}{1000 (2) (3)} = 2.18^k = 7.05^k$$

$$P_4 = \frac{20 \text{ psf} \times 12.5 \times 24}{1000 (2) (3)} = 1.00 = 8.05^k$$

$$P_5 = \frac{20 \text{ psf} \times 25 \times 32.33}{1000 (2) (3)} = 2.70 = 5.22^k$$

$$P_6 = \frac{20 \text{ psf} \times 25 \times 30.25}{1000 \times (2) (3)} = 2.52 = 7.74^k$$

$$P_7 = \frac{20 \text{ psf} \times 12.5 \times 28.2}{1000 \times (2) (3)} = 1.18^k = 8.92^k$$

Rod	FORCE	SIZE
d & e	$= \frac{35.36}{25.0} (2.52) = 3.57^k$	1/2" φ

b	$= \frac{35.36}{25.0} (4.87) = 6.89^k$	3/4" φ
---	--	--------

c	$= \frac{35.36}{25.0} (7.05) = 9.98^k$	7/8" φ
---	--	--------

d	$= \frac{34.66}{25.0} (8.05) = 11.16^k$	7/8" φ
---	---	--------

f	$= \frac{35.36}{25.0} (5.22) = 7.39^k$	3/4" φ
---	--	--------

g	$= \frac{35.36}{25.0} (7.74) = 10.95^k$	7/8" φ
---	---	--------

Rod	FORCE	SIZE
h	$= \frac{27.25}{25.0} (8.92) = 9.73^k$	3/4" φ

j	$= \frac{30.42}{25.0} (8.92) = 10.86^k$	7/8" φ
---	---	--------

ALLOWABLE LOAD

1/2" φ = 4.17<sup>k</sup>

3/4" φ = 9.80<sup>k</sup>

7/8" φ = 13.52<sup>k</sup>



**VARCO-PRUDEN**  
EVANSVILLE, WISCONSIN 53536

①